

Jabra GN

Made for
iPhone | iPad | iPod

Works with
android

ENHANCE SELECT 50

User guide

Receiver-In-Ear hearing aids

Life is richer when you can hear it.™

FDA warnings and cautions

WARNING: If you are younger than 18, do not use this

You should go to a doctor, preferably an ear-nose-throat doctor (an ENT), because your condition needs specialized care. Over-the-counter (OTC) hearing aids are only for users who are age 18 or older.

This OTC hearing aid is for users who are 18 and older. People who are younger than 18 with hearing loss should see a doctor, preferably an ENT, because they may need medical testing and management. Hearing loss can affect speech and learning, so professional fitting and continuing care are also important.

**WARNING:****When to See a Doctor**

If you have any of the problems listed below, please see a doctor, preferably an ear-nose-throat doctor (an ENT).

- Your ear has a birth defect or an unusual shape. Your ear was injured or deformed in an accident.
- You saw blood, pus, or fluid coming out of your ear in the past 6 months
- Your ear feels painful or uncomfortable
- You have a lot of ear wax, or you think something could be in your ear
- You get really dizzy or have a feeling of spinning or swaying (called vertigo)
- Your hearing changed suddenly in the past 6 months
- Your hearing changes: it gets worse then gets better again

- You have worse hearing in one ear
- You hear ringing or buzzing in only one ear.

This hearing aid should not cause pain when inserting it

Remove this device from your ear if it causes pain or discomfort when you insert or place it. To try again, make sure to follow the instructions. If you feel pain or discomfort again, contact the manufacturer. If your pain or discomfort doesn't go away, contact your hearing healthcare professional. You can also report this to FDA as an adverse event according to the instructions that appear later.



CAUTION:

This is not hearing protection

You should remove this device if you experience overly loud sounds, whether short or long-lasting. If you're in a loud place, you should use the right kind of hearing protection instead of wearing this device. In general, if you would use ear plugs in a loud place, you should remove this device and use ear plugs.

The sound output should not be uncomfortable or painful

You should turn down the volume or remove the device if the sound output is uncomfortably loud or painful. If you consistently need to turn the volume down, you may need to further adjust your device.

You might need medical help if a piece gets stuck in your ear

If any part of your hearing aid, like the eartip (dome), gets stuck in your ear, and you can't easily remove it with your fingers, get medical help as soon as you can. You should not try to use tweezers or cotton swabs because they can push the part further into your ear, injuring your eardrum or ear canal, possibly seriously.



NOTE:

If you remain concerned, consult a professional

- If you try this device and continue to struggle with or remain concerned about your hearing, you should consult with a hearing healthcare professional.

What you might expect when you start using your hearing aid

- A hearing aid can benefit many people with hearing loss. However, you should know it will not restore normal hearing, and you may still have some difficulty hearing over noise. Further, a hearing aid will not prevent or improve a medical condition that causes hearing loss.
- People who start using hearing aids sometimes need a few weeks to get used to them. Similarly, many people find that training or counseling can help them get more out of their devices.
- If you have hearing loss in both ears, you might get more out of using hearing aids in both, especially in situations that make you tired from listening – for example, noisy environments.

Tell FDA about injuries, malfunctions, or other adverse events

- To report a problem involving your hearing aid, you should submit information to FDA as soon as possible after the problem. FDA calls them “adverse events”, and they might include: skin irritation in your ear, injury from the device (like cuts or scratches, or burns from an overheated battery), pieces of the device getting stuck in your ear, suddenly worsening hearing loss from using the device, etc. Instructions for reporting are available at <https://www.fda.gov/Safety/MedWatch>, or call 1-800-FDA-1088. You can also download a form to mail to FDA.

Table of Contents

FDA warnings and cautions	2
Introduction	7
What is in the box?	9
Your hearing aid	10
Preparing your hearing aids for use	13
Placing your hearing aids in your ears	17
Ensuring a proper fit of your hearing aid	19
Removing your hearing aids from your ears	21
Using your hearing aids	22
Using a telephone	24
Advanced options	25
Wireless accessories	29
Cleaning and caring for your hearing aids	30
General warnings and cautions	45
Cyber security	47
Troubleshooting	48
Regulatory information	51
Technical specifications	56
Additional information	57

Introduction

Thank you for choosing Jabra Enhance hearing aids. We recommend that you use your hearing aids every day.



NOTE:

- Read this booklet carefully BEFORE using your hearing aids.
- Visit jabraenhance.com/start to learn how to wear your hearing aids, pair them to your mobile device and download the Jabra Enhance Select app.

Intended use

The hearing aid is intended to amplify sound for individuals 18 years of age or older with perceived mild to moderate hearing impairment. The device is intended for direct-to-consumer sale and use without the assistance of a hearing care professional.

User profile

The hearing aid is intended to be used by adults 18 years of age or older.

The hearing aid is intended to be used by lay persons.

Therapeutic indications

Perceived mild to moderate hearing impairment.

Symbols



WARNING: Points out a situation that could lead to serious injuries.



Legal manufacturer.



CAUTION: Indicates a situation that could lead to minor and moderate injuries.



NOTE: Advice and tips.



Date of manufacture.



Follow instructions for use. (Logo in blue)



Unique Device Identification.



Equipment includes an RF transmitter.



Do not dispose of electronic devices or batteries with ordinary household waste. They should be disposed of at sites intended for electronic waste.
Please note: There may be specific regulations in your country.

What is in the box?

The following items are included in the package:

- A set of 2 hearing aids
- Extra batteries, type 312
- A "clamshell" storage case
- Extra domes. See "Changing your hearing aid domes", page 33
- A cleaning cloth and brush. See "Cleaning tools", page 31
- A wax guard kit. See "Changing the wax filter", page 37
- An ear measuring tool for receiver wires. See "Replacing the receivers", page 40
- A tool for receiver wire replacement. See "Replacing the receivers", page 40
- A kit of cards to get you started
- An App (Getting Started) Guide with instructions for downloading and connecting to the Jabra Enhance Select app
- This user guide.

If anything is missing, please contact customer support at Jabra Enhance. See the back page for contact information.

Your hearing aid

Zinc-Air battery model (61)

1. Receiver wire
2. Receiver
3. Dome (an open dome is shown)
4. Push button
5. Microphone inlets
6. Battery compartment
7. Model and serial number (in the battery compartment)

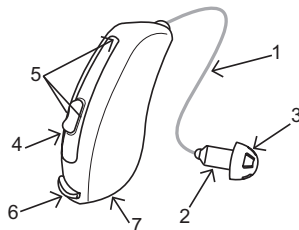

Replacement parts and optional extras

Contact Jabra Enhance for further information and ordering. See the back page for contact information.

Domes



Tulip dome



Closed dome



Open dome

Tulip domes are one size. Closed and open domes are available in different sizes.
Domes are all light grey.



NOTE: Only use domes supplied by Jabra Enhance.

See "Changing your hearing aid domes", page 33 for instruction on how to change the domes.

Receiver

The receiver consists of a connector for attachment to the hearing aid, a receiver wire, the receiver itself, a replaceable dome, and a replaceable wax filter.

Your receivers are color-coded.
Left = blue. Right = red.



Sport lock (optional)

The sport lock helps keep your hearing aids in place when you are physically active.

See "Mounting a sport lock on the receiver", page 43 for instruction on how to mount the sport lock on the receiver.



Preparing your hearing aids for use

Battery warnings



WARNING: Batteries contain dangerous substances and should be disposed of carefully in the interest of your safety and for the environment. Please note:

- Keep hearing aid batteries away from pets, children, and people with cognitive, intellectual or mental health challenges.
- Never put a hearing aid battery in your mouth.
- Never swallow batteries nor place them inside any part of the body, as the battery can cause serious injuries. If a battery has been swallowed or placed inside any part of the body, seek immediate medical attention.
- Do not recharge zinc-air batteries. They may leak or explode.
- Do not attempt to dispose of batteries by burning them.
- Used batteries are harmful to the environment. Please dispose of them according to local regulations.
- Batteries may leak. Remove the battery if you leave the hearing aids unused for longer periods.
- If the batteries are not inserted correctly, the device will not work and the batteries may build up heat. If this happens, please remove the batteries.



NOTE:

- Always use new zinc-air batteries that have a minimum remaining shelf life of one year.
- To save battery power, turn off your hearing aids when they are not in use.

Inserting the battery into your hearing aid

Your hearing aids use type 312 batteries.

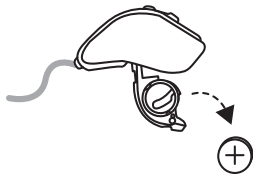

1. Open the battery door with your fingernail. Remove the old battery (if there is one).

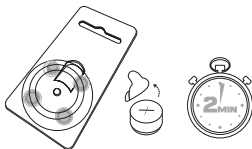

2. Remove the packaging and protective foil from the new battery. Wait for **two minutes** while the battery activates.



3. Insert the new battery, with the plus (+) sign correctly positioned, into the battery compartment door. **Do not** insert it directly into the hearing aid.

4. Close the battery door.



NOTE:

- To save battery power, turn off your hearing aids when they are not in use.

- At night, turn off the hearing aids. Open the battery door completely to allow moisture to evaporate and prolong the hearing aids' life span.

Low battery alert

When the batteries are low on power, the volume in your hearing aids will momentarily reduce and a melody will play every 15 minutes until there is no more power - then your hearing aids will turn off.





NOTE: Keep extra batteries with you.

Low battery alert when paired with wireless accessories (optional)



NOTE:

- Your batteries will run out faster when you use wireless functions like streaming from your smart device or from your TV with our TV streamer. As the battery power declines, the wireless functions stop working. A short melody will play every five minutes to let you know that the battery power is low. The table below shows the functionality with different battery charge levels.

Battery level	Signal	Hearing aid	Remote control	Streaming
Fully charged		✓	✓	✓
Low	 4 even tones	✓	✓	x
Depleted	 3 even tones and 1 longer tone	✓	x	x

These will work again when you insert a new battery.

Placing your hearing aids in your ears

How to tell left from right

If you have two hearing aids, they may be programmed differently. One for your left ear, the other for your right. Do not swap them. Please pay attention to this when cleaning, storing, and inserting the hearing aids.



Left hearing aid (blue marking)



Right hearing aid (red marking)

When you place your left and right hearing aid side by side (as shown), the receivers should turn inwards. Then the hearing aids are in the correct side for insertion.

Inserting the receiver dome into your ear

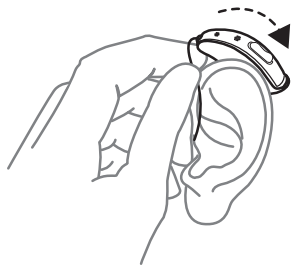

1. Hang the hearing aid over the top of your ear.

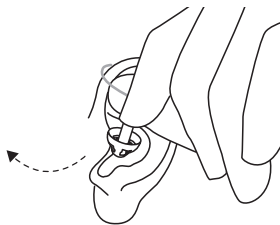

2. Hold the receiver wire where it bends and gently place/push the receiver dome into your ear canal.

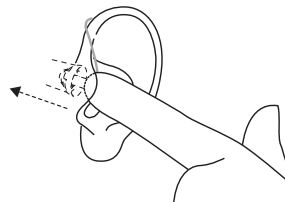

3. Push the dome far enough into your ear canal so that the receiver wire rests against your head. You can check in a mirror.



CAUTION: Never attempt to modify the shape of the receiver wire yourself.

Sport lock

If you have ordered sport locks with your hearing aids and mounted them as instructed on page 43, insert them as follows:

To insert a hearing aid with a sport lock:

1. Insert the hearing aid as usual
2. Tuck the sport lock into the bottom of the concha (the part of your ear just outside the ear canal).



NOTE: Sport locks may become stiff, brittle, or discolored over time and need replacement. Contact Jabra Enhance for further information and ordering. See the back page for contact information.

Ensuring a proper fit of your hearing aid

To check if the hearing aid is placed correctly:

- The body of the hearing aid should be placed just behind your ear.
- When inserted in your ear canal, the dome should feel secure and comfortable. See "Inserting the receiver dome into your ear", page 18 on how to insert the dome.
- The receiver wire should fit comfortably around the top of your ear.
 - If the wire is too long, it may bend away from your ear.
 - If the wire is too short, it may feel tight and may pull the dome partly out of your ear.





NOTE:

- To avoid whistling, ensure that the receiver wire and dome fit correctly into your ear. If you continue to experience whistling, check the troubleshooting guide for other possible reasons and solutions.
- If the receiver wire of the hearing aid does not rest against the side of your head, try using a smaller dome size. (See page 33 for dome replacement). A different receiver length may also be needed. (See "Replacing the receivers", page 40).
- If you are still unable to receive an appropriate fit, contact Jabra Enhance. See the back page for contact information.

Removing your hearing aids from your ears

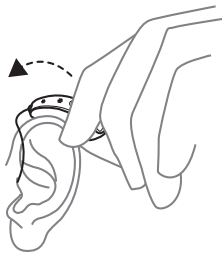

1. Lift the hearing aid off your ear.

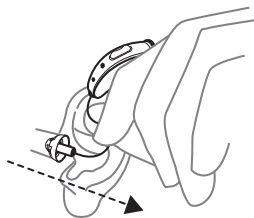

2. Hold the receiver wire with your thumb and index finger where it bends and pull the dome out of your ear canal.

Using your hearing aids

Turning your hearing aids on and off

Once you have placed the hearing aids on your ears, you can turn them on.

Your hearing aids always start in program 1 at the pre-set volume.



To turn your hearing aid on, close the battery door.

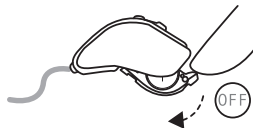

To turn the hearing aid off, open the battery door (with your fingernail).

Smart Start

Smart Start delays the time before your hearing aid turns on after you close the battery door. With this function activated, you will hear a beep for each second of the delay period (either 5 or 10 seconds).

Listening programs

The hearing aids are programmed for the following programs that can help you in specific situations.

Listening Programs	Use
1. All-Around (1 beep)	The best option if you want only one program.
2. Restaurant (2 beeps)	For use in noisy places such as restaurants and social gatherings.
3. Music (3 beeps)	For listening to music.
4. Outdoor (4 beeps)	For outdoor use (to reduce wind noise).

Using the push button

Controlling the volume

- To turn the volume up, press the button on the right hearing aid for less than 1 second.
- To turn the volume down, press the button on the left hearing aid for less than 1 second.

Changing programs

- Your hearing aids will beep to confirm the change. The number of beeps indicates which program you have selected.
- To get back to the default listening program, keep scrolling, or turn your hearing aids off and on again.



NOTE: If you have two hearing aids with synchronization enabled, changing the program on one hearing aid automatically applies the change to the second hearing aid as well.

Streaming

You can activate streaming from the Jabra Enhance Select app.

Using a telephone

Your hearing aid allows you to use your telephone as you normally do. Finding the optimal position for holding the phone may require practice.

The following suggestions may be helpful:

1. Hold the telephone up to your ear canal or hold it close to the hearing aid microphones as illustrated.
2. If you hear whistling, try holding the telephone in the same position for a few seconds. The hearing aid may be able to cancel the whistling.
3. You can also try holding the telephone slightly away from the ear.

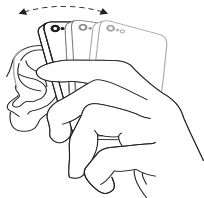

Mobile phones

Your hearing aids comply with the most stringent Standards of International Electromagnetic Compatibility. Any degree of disturbance can be due to the nature of your particular mobile phone or of your wireless telephone service provider.



NOTE:

- If you have a mobile device, you can pair it to connect directly to your hearing aids. See "Advanced options", page 25.
- If you find it difficult to get a good result while using your mobile phone, see jabraenhance.com/accessories for an overview of wireless accessories that may be useful for you. See also "Wireless accessories", page 29.

Advanced options

Using your hearing aids with iPhone, iPad, and iPod touch (optional)

The advanced models of our hearing aids are Made for iPhone®, iPad® and iPod touch®, which allow for direct audio streaming and control from these devices.

Streaming from an Android™ smartphone

Some Android smartphones can stream audio directly to the advanced models of our hearing aids. Your device must be running Android 10 or newer and it must have the Android Streaming for Hearing Aids feature as well.



NOTE:

- See jabraenhance.com/compatibility for a list of compatible devices and operating system requirements.
- Visit jabraenhance.com/start to learn how to pair your hearing aids to your mobile device and download the Jabra Enhance Select app.
- If your Bluetooth® enabled Android smartphone does not stream directly to your hearing aids, you can use our Phone Clip+ for streaming capabilities.

Controlling your hearing aids with the mobile device app

The Jabra Enhance Select app lets you control your hearing aids right from your mobile device. For example, you can choose different listening programs based on your current environment. It will also enable you to receive important updates for your hearing aids, and your hearing professional can fine-tune your settings for you through the app.

- Use only our compatible mobile device app with your hearing aids.
- Do not disable app notifications.
- Install updates to keep the app working correctly.
- To get step-by-step instructions on how to connect your hearing aids with the Jabra Enhance Select app, refer to the printed "Get Connected" guide that came with your box.



Online Services (optional)

If you have signed up to use Online Services available with your hearing aids, you can allow your hearing aids to be adjusted remotely.

All you need is a compatible mobile device with internet enabled. This allows you to:

- Request assistance remotely to adjust your hearing aids to be a better fit for you.
- Keep your hearing aids up to date with the latest software to ensure the best performance possible.

This service only works if your mobile device is connected to the internet. Visit jabraenhance.com/start to learn how to pair your hearing aids to your mobile device and download the Jabra Enhance Select app.

For optimum performance, make sure the hearing aids are connected to the Jabra Enhance Select app and placed close to the iPhone, iPad, iPod touch, or the Android smartphone before applying the changes.



NOTE: Your hearing aids shut down during the installation and update process.

Flight Mode (optional)

Your hearing aids can be controlled from your mobile device or Remote Control, an option that can be added by Jabra Enhance. However, in some areas you are requested to turn off wireless communication.



CAUTION: When boarding a flight or entering an area where RF transmitters are prohibited, wireless functionality must be deactivated.



NOTE: Both hearing aids must be set in Flight mode - even with synchronization enabled.

Turning off wireless communication (enter Flight Mode)

1. Open and close the battery door on each hearing aid three times within 10 seconds.
2. A 10-second double tone (♪♪) means the hearing aid is now in Flight Mode.



NOTE: Both hearing aids must be set in Flight mode - even with synchronization enabled.

Activating wireless communication (exit Flight Mode)

1. Open and close the battery door on each hearing aid once.
2. Wireless communication will be activated after 10 seconds.



NOTE: It is important to wait an additional 15 seconds after wireless function resumes before opening and closing the battery compartment again for any reason. Flight mode will resume if you open and close the battery compartment during this 15 second window.

Wireless accessories

Our wireless eco-system features a comprehensive range of seamlessly integrated wireless accessories. These let you stream high quality stereo sound and speech directly to your hearing aids. See jabraenhance.com/accessories for an overview of wireless accessories that may be useful for you.

Available wireless accessories and their features

- **A TV streamer** streams audio from a TV and most other audio sources to your hearing aids at a volume that suits you.
- **A phone clip** streams phone conversations and stereo sound to both hearing aids and doubles as a remote control.
- **A wireless microphone.** It doubles as a table microphone. Furthermore, it has a built-in telecoil that allows it to connect with a teleloop system, a connector for an FM receiver, and a mini-jack input for wired streaming of audio from a computer or music player.

Accessing wireless accessories

You can activate streaming from the Jabra Enhance Select app.



NOTE:

- You should only use recommended wireless accessories with your wireless hearing aids.

Cleaning and caring for your hearing aids

Care and maintenance

Please follow the advice below to have the best user experience and to prolong the life of your hearing aids.

- Keep your hearing aids dry and clean.
- Open the battery door to dry your hearing aids when you are not wearing them.
- Wipe the hearing aids with a soft cloth after use to remove grease or moisture.
- Do not wear your hearing aids when putting on cosmetics, perfume, aftershave, hairspray, suntan lotion, etc. These might discolor the hearing aid or get into the hearing aid causing damage.
- Do not immerse your hearing aid in any liquid.
- Keep your hearing aids away from excessive heat and intense direct sunlight. The heat may deform the shell, damage the electronics, and deteriorate the surface.
- The hearing aid is dust, splash, and water resistant:
 - The hearing aid has IP6X dust resistance. Avoid exposure to extensive dust.
 - The hearing aid has IPX8 water resistance. Avoid exposure to liquids, and do not swim, shower or sauna while wearing the device.

Daily maintenance

It is important to keep your hearing aid clean and dry. On a daily basis, clean the hearing aids using a soft cloth or tissue. In order to avoid damage due to humidity or excessive perspiration, the use of a drying kit is recommended.



WARNING: Always turn your hearing aids off while cleaning and maintaining them.



Cleaning tools

1. Soft cloth.
2. Brush for cleaning. Use the brush on all surfaces and orifices. Also use your brush for daily cleaning and battery handling.
3. Magnet. Use the magnet to lift and replace the battery.

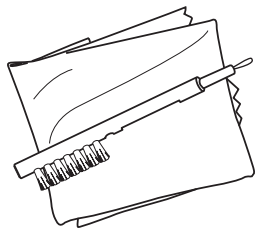

If the microphone inlets are clogged, gently brush across the microphone inlets with the brush.

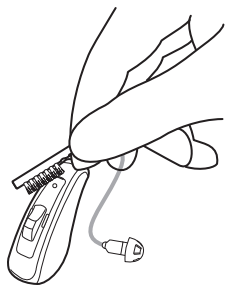

WARNING: Do not use force to press the bristles on the small brush into the inlets because the microphones may be damaged.



CAUTION: Do not use alcohol or other solvents to clean your hearing aid or the protective coating will be damaged.



NOTE: If the microphone inlets remain clogged after brushing the exterior, ask a hearing care professional to help you clean them.

Changing your hearing aid domes

You should change your domes every 3 months or more often. For example, if a dome is filled with earwax, replace it with a new one. If the hearing aids sound more quiet, this might indicate that new domes are needed. See also "Changing the wax filter", page 37.

If you don't know your dome size, mount different sizes, one at a time, on the receiver and test them in your ear. Choose a dome size that fits snugly, yet comfortably in the ear canal.



NOTE:

- Incorrect dome replacement can result in a dome being left in your ear when you remove your hearing aid.
- If you don't feel confident performing this task, please contact Jabra Enhance support. See the back page for contact information.



CAUTION:

- If you suspect that you have a dome, wax filter or other object stuck in your ear, consult a hearing care professional or a physician. These objects can be harmful and can cause an infection in your ear.
- Use only accessories intended for use with your hearing aids. Contact Jabra Enhance for further information and ordering.

Standard domes

The illustrations show an open dome, but the procedure is the same for closed domes. Follow these instructions to replace your domes.

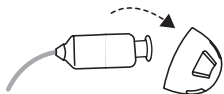

1. Remove the used dome by pulling it off the receiver and then discard it. This may require a bit of force.



3. Check that the dome is securely mounted by carefully lifting the lower part of the dome and verifying that the collar completely covers the ribbed end of the receiver.



NOTE: Change the dome at least every three months.

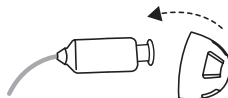

2. Push the new dome over the ribbed end of the receiver.

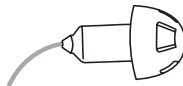

4. OK.

Tulip domes

To change a tulip dome, follow these instructions:

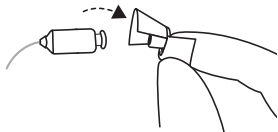

1. Remove the used dome by pulling it off the receiver and then discard it. This may require a bit of force.

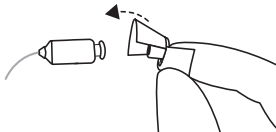

2. Push the largest petal back, then press the tulip dome over the ribbed end of the receiver.

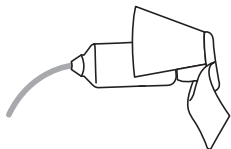

3. Check that the tulip dome is securely mounted by verifying that the collar completely covers the ribbed end of the receiver.

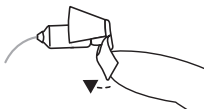

4. Push the larger petal toward the receiver.



This illustration shows a correctly mounted tulip dome. Ensure the large petal is outside the small petal.

Changing the wax filter

The wax filter is located at the inward end of the receiver.

The wax filter helps keep earwax away from the components of the hearing aid. You must replace it on a regular basis. It will depend on how much wax your ears produce.

You will need your box of wax filter tools.



NOTE: Hearing aids should not be used without a wax filter installed for any amount of time. Using the hearing aid without a wax filter can cause permanent damage to the receiver.

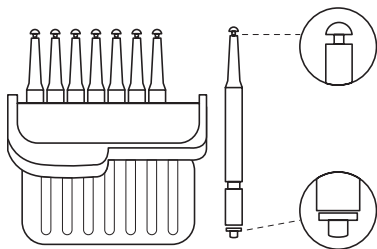

Box of 8 wax filter tools.

The wax filter tool has two functions: a removal tip to collect the used filter, and a replacement tip with a white filter.

Removing the old wax filter

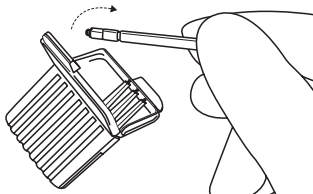
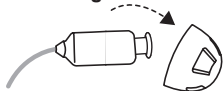

1. Remove the dome from the receiver.
2. Open the wax filter case and take out one of the tools. Each tool has a small hook (removal tip) in one end and a new wax filter in the other.

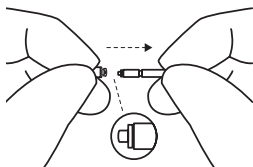
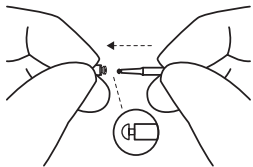

3. Insert the removal tip into the used wax filter and then pull the tool straight out. It is important to pull it straight and not on an angle.

Inserting the new wax filter

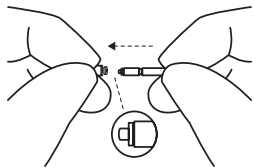

1. Insert the other end of the tool into the sound outlet (the end with the replacement filter).

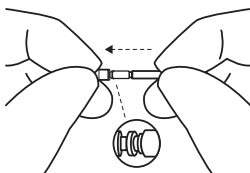

2. Gently press the replacement straight into the sound outlet until the outer ring is touching the sound outlet.

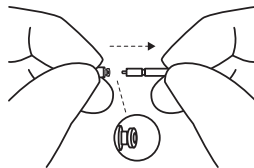

3. Pull the tool straight out. Your new wax filter will remain in place. Re-attach your dome or a replacement dome.



NOTE: If you don't feel confident performing this task, please contact Jabra Enhance support. See the back page for contact information.



CAUTION: Only use original consumables from the manufacturer (e.g., domes and wax filters).

Replacing the receivers

If you are unable to achieve an appropriate fit of the receiver to your ear, you may need another length of receiver wire. Contact Jabra Enhance for further information and ordering. See the back page for contact information.

The support team will be available to walk you through the measurement procedure, which is also described here:

Determine the length of the receiver wire before ordering

1. Use the ear measuring tool supplied with your hearing aids to measure the vertical distance from the top of the ear where it meets the head to the top of the ear canal.
2. Locate the corresponding size number (0, 1, 2, 3 or 4) on the tool and state it when you order.

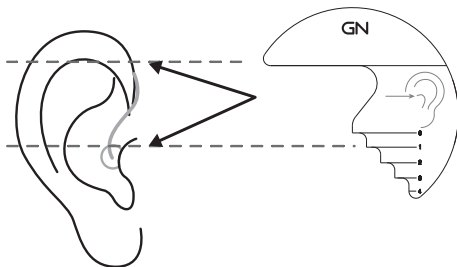

Replace the receiver

When you have received the new receivers, follow this procedure to replace them:

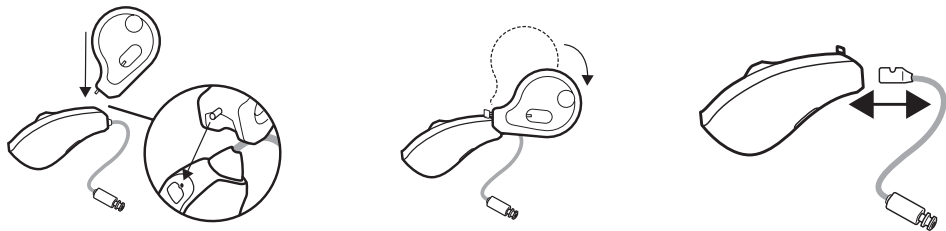

1. Use the receiver removal tool from your box. Start removing the receiver by inserting the tip of the receiver tool into the small hole at the front of the receiver lock.
2. Tilt the receiver tool downwards until the lock release disengages from the body of the hearing aid.
3. Pull the receiver away from the body of the hearing aid.

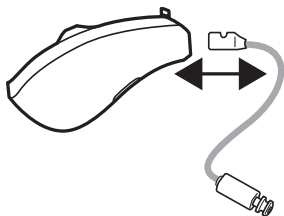

4. Attach a new receiver by inserting the receiver attachment into the top of the hearing aid.

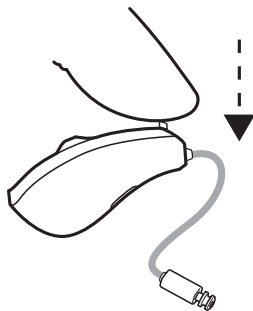

5. Push the lock release down until it is flush with the back of the hearing aid.

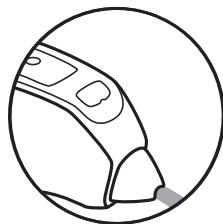

6. The receiver is now attached and ready.



NOTE:

- If you don't feel confident performing this task, please contact Jabra Enhance support. See the back page for contact information.

Mounting a sport lock on the receiver

If you have acquired a sport lock for your hearing aid, follow this procedure to fasten it on the receiver:

1. Remove the dome. See "Changing your hearing aid domes", page 33.
2. Position the receiver with the receiver wire up, and the sport lock with the tail pointing down.
3. Thread the sport lock over the receiver nozzle on to the body of the receiver.
4. Ensure the sport lock is fully seated on the receiver.
5. The sport lock is now attached and ready.

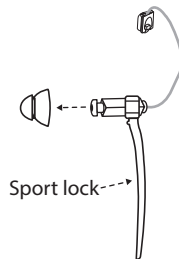

NOTE: If you don't feel confident performing this task, please contact Jabra Enhance support. See the back page for contact information.

Storing your hearing aids

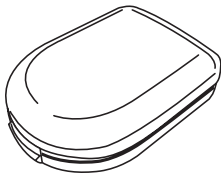

1. The best storage for your hearing aids is the case they came in.



WARNING:

- Never put a hearing aid battery in your mouth.
- Keep hearing aid batteries away from pets, children, and people with cognitive, intellectual or mental health challenges.
- Never swallow batteries nor place them inside any part of the body, as the battery can cause serious injuries. If a battery has been swallowed or placed inside any part of the body, seek immediate medical attention.

2. When they are not being worn, keep your hearing aids dry by leaving the battery doors open.

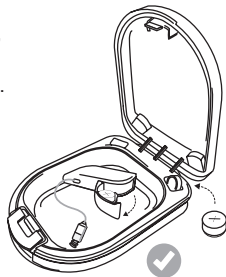

General warnings and cautions



WARNING:

- See also "FDA warnings and cautions", page 2.
- Keep hearing aids away from pets, children and people with cognitive, intellectual or mental health challenges.
- Never leave children, or people with cognitive, intellectual, or mental health challenges unsupervised while using their hearing aids. Hearing aids contain small pieces that can be dangerous if swallowed.
- Swallowing a hearing aid can result in choking, and can be harmful to your health.
- If any part of a hearing aid is swallowed, seek immediate medical attention.
- Do not wear your hearing aids while being exposed to radiation. Some types of radiation, such as from MRI or CT scanners, can affect the settings in your hearing aids, causing malfunction and potentially damage to your hearing.
- Other types of radiation, such as burglar alarms, room surveillance systems, mobile phones, metal detectors, and radio equipment will not damage your hearing aids. However, they may briefly affect the sound quality in your hearing aids and may create undesired sounds.
- Never use your hearing aids in places with explosive gases such as mines, oil fields, or similar locations unless these areas are certified for hearing aid use. Using your hearing aids in places that are not certified for hearing aid use can be dangerous.
- Do not attempt to dry your hearing aids in an oven, microwave oven, or other heating equipment. This will cause them to melt and may cause burns to your skin.

- External devices connected to the electrical input must be safe according to the requirements of IEC 60601-1, IEC 60065, EN/IEC 62368-1, or IEC 60950-1, as appropriate.
- No modification of this device is allowed.



CAUTION:

- Use your hearing aids as recommended. Incorrect use may damage your hearing.
- Do not use a broken or modified hearing aid. It may not work properly and may be harmful to your hearing. It may also cause scratches or sores due to sharp edges.
- Use only original consumables from the manufacturer (e.g., wax guards).
- Use only accessories intended for use with your hearing aids. Contact Jabra Enhance for further information and ordering.
- Do not try to modify the shape of your hearing aid or accessories. This can cause skin reactions or sharp edges leading to scratches or sores.
- Your two hearing aids may each be programmed differently. Do not swap them as this could damage your hearing. Your hearing aids are color-coded. Left = blue. Right = red.
- If you have a sore or injury where your hearing aid touches your ear or head, continued use of the hearing aid may cause it to worsen or prevent it from healing. Consult a hearing care professional for assistance.
- Do not allow others to use your hearing aids as this can damage their hearing.
- When using wireless functions, your hearing aid uses low-powered digitally coded transmissions to communicate with other wireless devices. It is possible, but not likely, that other electronic devices will be affected. If this happens, move the hearing aid away from the affected electronic device.
- Turn off hearing aid wireless functionality when this is required.

Cyber security

Failing to follow these precautions can compromise the information security of your hearing aid and potentially cause hearing loss or tinnitus.



CAUTION:

- Only connect your hearing aid to a trusted computer or mobile device, or one used by a hearing care professional.
- For 3 minutes after being turned on, your hearing aid is open to connections. Do not restart your hearing aid if requested by someone you don't trust as this may compromise the safety of your device.
- If your device plays the pairing sound at an unexpected time, this could indicate someone has gained access to your device.
- Only connect your hearing aid to the official mobile device app.
- Only apply remote fine tuning updates that you are expecting.
- Always use the latest available software update for your hearing aid.
- Only accept live assistance calls from the hearing care professional that you are expecting.

Troubleshooting

Issue	Potential cause	Potential solution
Receiver wire doesn't fit comfortably	Is the receiver inserted correctly in the ear, and is the receiver wire length correct?	See "Inserting the receiver dome into your ear", page 18, or contact Jabra Enhance. See the back page for contact information.
Feedback or "whistling"	Is your dome inserted correctly in your ear?	Put it back in.
	Is the volume very loud?	Reduce the volume.
	Is the receiver wire broken?	Contact Jabra Enhance for a replacement.
	Are you holding an object (e.g., a hat or a telephone mouthpiece) close to the hearing aid?	Move your hand away to create more space between the hearing aid and the object.
	Is your ear full of wax?	Visit your doctor.

Issue	Potential cause	Potential solution
No sound	Is the hearing aid turned off?	Turn it on.
	Is there a battery in the hearing aid?	Insert a new battery.
	Is the battery still good?	Replace with a new battery.
	Is the receiver wire broken?	Contact Jabra Enhance for a replacement.
	Does the hearing aid need cleaning, or is the wax filter clogged?	Clean your hearing aids and change your wax filters.
	Is your ear full of wax?	Visit your doctor.
Sound is distorted, spluttering, or weak?	Is the battery dead?	Replace with a new battery.
	Is the battery dirty?	Clean it or replace it with a new one.
	Is the receiver wire broken?	Consult your hearing care professional. Contact Jabra Enhance for a replacement.
	Is there moisture in your hearing aid?	Use a desiccant (drying kit).

Issue	Potential cause	Potential solution
Battery drains very quickly.	Did you leave your hearing aid on for long periods of time?	<p>Always turn off your hearing aid when you are not using it, e.g. at night.</p> <p>Your batteries will run out faster when you use wireless functions like streaming from your smart device or from your TV with our TV streamer.</p>
	Is the battery old?	Check the battery packaging.

Regulatory information

Warranties and repairs

The manufacturer provides a warranty on hearing aids in the event of defects in workmanship or materials, as described in applicable warranty documentation. In its service policy, the manufacturer pledges to secure functionality at least equivalent to the original hearing aid. As a signatory to the United Nations Global Compact initiative, the manufacturer is committed to doing this in line with environment-friendly best practices. Hearing aids therefore, at the manufacturer's discretion, may be replaced by new products or products manufactured from new or serviceable used parts, or repaired using new or refurbished replacement parts. The warranty period of hearing aids is designated on your warranty card, which is provided by Jabra Enhance. For full details, visit jabraenhance.com/terms-and-conditions.

For hearing aids that require service, please contact Jabra Enhance for assistance.

Hearing aids that malfunction must be repaired by a qualified technician. Do not attempt to open the case of hearing aids, as this will invalidate the warranty.

Ambient conditions

Temperature test

Our hearing aids are subjected to various tests in temperature and damp heating cycling between -25 °C (-13 °F) and +70 °C (+158 °F) according to internal and industry standards.

During use

During normal operation the temperature should not exceed the limit values of 0 °C (+32 °F) to +45 °C (+113 °F) at a relative humidity of 90%, non-condensing. An atmospheric pressure between 500 hPa and 1100 hPa is appropriate.



NOTE: During use, your hearing aids may reach temperatures up to +43°C (+109°F).

During transport or storage

During transport or storage, the temperature should not exceed the limit values of -20°C (-4°F) to +60°C (+140°F) at a relative humidity of 90% RH, non-condensing (for a limited time).

Warm-up time: 5 minutes.

Cool-down time: 5 minutes.

Expected service lifetime

The expected service lifetime for the product when used as intended is:

Product	Lifetime
Hearing aid	5 years
Dome	3 months
Receivers	2 years
Electronic accessories (e.g., wireless accessories)	5 years

Non-clinical testing

The devices covered within this user guide have undergone tests for the relevant non-clinical performance testing and biological endpoints in accordance with standards identified below:

- Electrical safety testing is performed according to IEC 60601-1:2005 + A1:2012+A2:2020, IEC 60601-2-66:2019, IEC 60601-1-11 Edition 2.0 2015-1, IEC 62133-2 Edition 1.0 2017- 02 and IEC 62368-1:2018/COR1:2020.
- Electromagnetic compatibility (EMC) testing is performed according to IEC 62479:2010, ANSI IEEE C63.19-2019 and IEC 60601-1-2:2014+A1:2020.
- Radio and Telecommunication testing is performed to be in compliance with applicable parts of the FCC rules in title 47 of the CFR.
- Electroacoustic testing is performed according to ANSI/ASA S3.22-2014 and ANSI/CTA 2051:2017
- Usability Engineering was performed in compliance with IEC 62366-1:2015

The devices covered in this user guide passed all tests for the relevant non-clinical performance testing and biological endpoints, namely cytotoxicity (ISO 10993-05:2009), sensitization, and intracutaneous reactivity (ISO 10993-10:2010).

Similarly, usability testing and software verification and validation demonstrated mitigation of risks to an acceptable level as well as reasonable assurance of safe and effective device performance.

Clinical data

The devices have been evaluated clinically through equivalence, and the devices have been compared to equivalent devices and similar devices on the market with similar intended purpose, e.g., to compensate for hearing impairment by amplifying and transmitting sound to the ear.

Based on technical and clinical data presented for the device in question, the equivalent predecessor and generally similar devices, it is concluded to support the clinical performance expressed in user needs and claims.

The clinical data leaves no questions open regarding clinical performance and is for this reason deemed sufficient.

Statement

This device complies with part 15 of the FCC rules and ISED rules. Its operation is subject to the following two conditions:

1. This device may not cause harmful interference.
2. This device must accept any interference received, including interference that may cause undesired operation.



NOTE: This equipment has been tested and found to comply with the limits for a Class B digital device, pursuant to part 15 of the FCC rules and ISED rules. These limits are designed to provide reasonable protection against harmful interference in a residential installation. This equipment generates, uses, and can radiate radio frequency energy and, if not installed and used according to the instructions, may cause harmful interference to radio communications.

However, there is no guarantee that interference will not occur in a particular installation. If this equipment does cause harmful interference to radio or television reception, which can be determined by turning the equipment off and on, the user is encouraged to try to correct the interference by one or more of the following measures:

- Redirect or relocate the receiving antenna.

- Increase the separation between the equipment and the receiver
- Connect the equipment to an outlet or a circuit that is different from the one to which the receiver is connected
- Consult the dealer or an experienced radio/TV technician for help.

Changes or modifications can void the user's authority to operate the equipment.

The products are in compliance with the following regulatory requirements:

- In the US: FCC CFR 47 Part 15, subpart C.

Type designations

Hearing aid type designations for models included in this user guide are:

VER12 02 Q, FCC ID: X26VER12 02 Q, IC: 6941C-VER12 02 Q.

This device includes an RF transmitter which operates in the frequency band of 2.4 GHz – 2.48 GHz.

Hearing aid variants

Mini Receiver In-the-Ear (RIE) hearing aids of type **VER12** with FCC ID X26VER12, IC number 6941C-VER12 and size **312** battery are available in the following variant(s):

QC361

Nominal RF output power transmitted is +1 dBm.

Technical specifications

RIE - MP receiver

QC361

Reference test gain (60 dB SPL input)	HFA	36	dB
Full-on gain (50 dB SPL input)	Max.	58	dB
	HFA	50	
Maximum output (90 dB SPL input)	Max.	116	dB SPL
	HFA	113	
Total harmonic distortion	500 Hz	0.3	%
	800 Hz	0.4	
	1600 Hz	0.7	
Equivalent input noise, w/o noise reduction		24	dB SPL
1/3 Octave Equivalent input noise, w/o Noise reduction	1600 Hz	11	dB SPL
Frequency range IEC 60118-0: 2015		100-8060	Hz
Current Drain (Quiescent/Operating)		1.13/1.19	mA

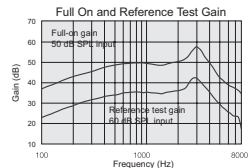
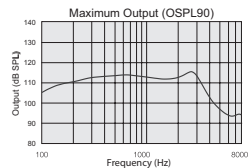

Data in accordance with ANSI S3.22-2014, IEC 60118-0:2015. Measured in a 2cc coupler.

Additional information

Acknowledgements

Portions of this software are written by Kenneth MacKay (micro-ecc) and licensed under the following terms and conditions:

Copyright © 2014, Kenneth MacKay. All rights reserved.

Redistribution and use in source and binary forms, with or without modification, are permitted provided that the following conditions are met:

- Redistributions of source code must retain the above copyright notice, this list of conditions and the following disclaimer.
- Redistributions in binary form must reproduce the above copyright notice, this list of conditions and the following disclaimer in the documentation and/or other materials provided with the distribution.

THIS SOFTWARE IS PROVIDED BY THE COPYRIGHT HOLDERS AND CONTRIBUTORS "AS IS" AND ANY EXPRESS OR IMPLIED WARRANTIES, INCLUDING, BUT NOT LIMITED TO, THE IMPLIED WARRANTIES OF MERCHANTABILITY AND FITNESS FOR A PARTICULAR PURPOSE ARE DISCLAIMED. IN NO EVENT SHALL THE COPYRIGHT HOLDER OR CONTRIBUTORS BE LIABLE FOR ANY DIRECT, INDIRECT, INCIDENTAL, SPECIAL, EXEMPLARY, OR CONSEQUENTIAL DAMAGES (INCLUDING, BUT NOT LIMITED TO, PROCUREMENT OF SUBSTITUTE GOODS OR SERVICES; LOSS OF USE, DATA, OR PROFITS; OR BUSINESS INTERRUPTION) HOWEVER CAUSED AND ON ANY THEORY OF LIABILITY, WHETHER IN CONTRACT, STRICT LIABILITY, OR TORT (INCLUDING NEGLIGENCE OR OTHERWISE) ARISING IN ANY WAY OUT OF THE USE OF THIS SOFTWARE, EVEN IF ADVISED OF THE POSSIBILITY OF SUCH DAMAGE.



NOTE: Use of the Made for Apple badge means that an accessory has been designed to connect specifically to iPhone, iPad, and iPod touch models, and has been certified by the developer to meet Apple performance standards. Apple is not responsible for the operation of this device or its compliance with safety and regulatory standards.

© 2023 GN Hearing A/S. All rights reserved. Jabra is a trademark of GN Audio A/S. Apple, the Apple logo, iPhone, iPad, iPod touch are trademarks of Apple Inc., registered in the U.S. and other countries. App Store is a service mark of Apple Inc., registered in the US and other countries. Android, Google Play and the Google Play logo are trademarks of Google LLC. The Bluetooth word mark and logos are registered trademarks owned by Bluetooth SIG, Inc.

Manufacturer according to FDA



GN Hearing A/S
Lautrupbjerg 7
DK-2750 Ballerup
Denmark

Notes

For support, please contact:

GN Consumer Hearing Corporation

dba Jabra Enhance

8001 E Bloomington Freeway

Bloomington, MN 55420

USA

(800) 854-2772

support@jabraenhance.com

JabraEnhance.com